

UNITS 2 & 3A Lakeside Retail Park Brynmawr
PROPOSED GRD FLOOR | Scale 1:100@A1

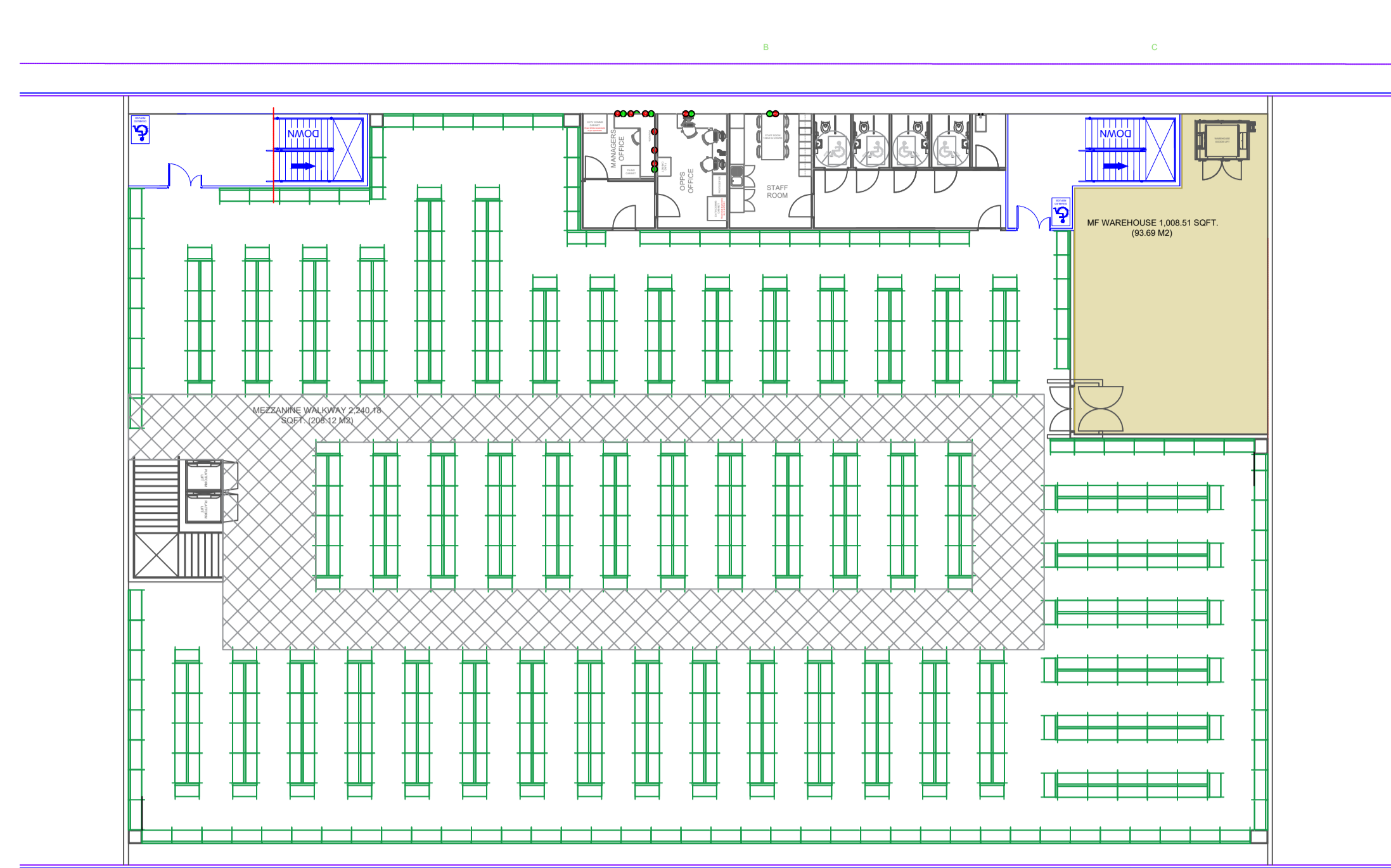

UNITS 2 & 3A Lakeside Retail Park Brynmawr
PROPOSED MEZZ FLOOR | Scale 1:200@A1

| | |
|--------------------------|----------|
| SQM Area's | |
| Grd Floor Total Area - | 1441 Sqm |
| Grd Floor Retail Area - | 1298 Sqm |
| Mezz Floor Total Area - | 1425 Sqm |
| Mezz Floor Retail Area - | 1205 Sqm |

| | | | |
|--------------------|--------------|--|---------|
| REV | DESCRIPTION | DATE | DRN. BY |
| | | | |
| CDS / group | | Unit 11, The Quadrangle, Abbey Park, Romsey, Hampshire, SO51 9DL Tel: 0945 674 4420 cds@group.co.uk © CDS Group Services Limited | |
| Proposed Grd Floor | | | |
| SCALE | DATE | DRAWN BY | |
| 1:100, 1:200 @ A1 | October 2021 | Graham Disley | |
| DRAWING No. | REV | REQ. BY | |
| 0000-400 | A | ** | |
| BRANCH | | | |
| BRYNMAWR | | | |